



\$495,000

BILLINGS, MT, 59102

<https://billingsrealtybrokers.com>

4929 Neibauer Rd. S21 T01S R25E COS 697 7.19 acres tax isd D00790 geo 03-0926-21-4-04-01-0000 Buyer to verify all information OUT SIDE city limits. NO Covenants .Easy access off Neibauer- West of S. 48th Street W. Verify with Yellowstone Planning office what you can do with this lot. Irrigation water \$200 yr. & 2 (two) [...]

- Residential
- Lots and Land
- Active

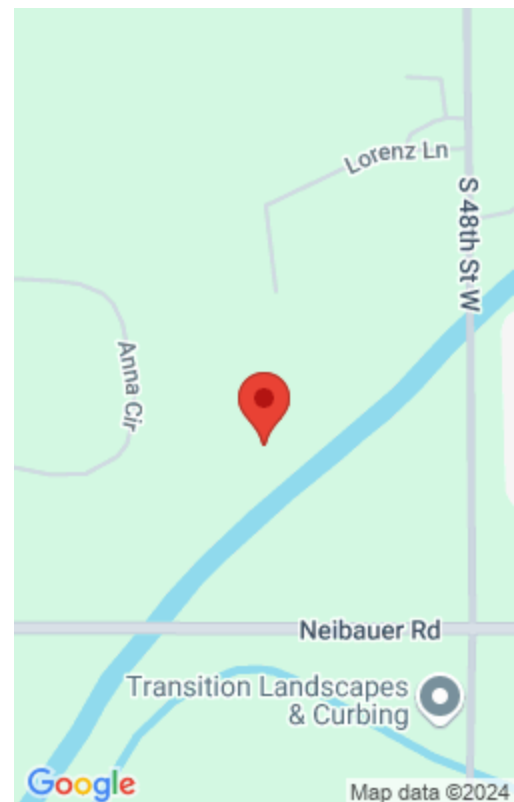

Basics

Category: Lots and Land

Status: Active

Lot size: 313196 sq ft

County Or Parish: Yellowstone

Type: Residential

Half baths: 0 half baths

Zone: Rural Residential 1

Number of Lots: 1

Building Details

Water: Available,Well,Yes

Amenities & Features

Sewer: Septic Tank,Yes

Electric: Available

Gas: Available,Buyer To Verify

Miscellaneous

Restrictions: No Restrictions,None,See Deed

Virtual Tour Link:

<https://www.propertypanorama.com/instaview/bmt/347724>

Road Frontage: 260

Subdivision: c/s 697

List Office Name: Landmark of Billings, Inc.

Street Surface: Asphalt

Possession: Immediate

Showing Instructions:

Call Before

Showing,Gate,Vacant

Parcel Number: d00790

Nearby Schools



Junior High School: Canyon Creek

High School: West

Elementary School: Canyon Creek

Fees and Taxes

Tot Taxes: \$1,665

