



\$834,000

BILLINGS, MT, 59106

<https://billingsrealtybrokers.com>

SHILOH ESTATES SUBD, S03, T01 S, R25 E, BLOCK 2, Lot 9

Gorgeous home on an acre! The amazing main level features two living rooms, one with a vaulted ceiling, gas fireplace, built-ins, and a patio door. The home also includes both formal and informal dining areas and a bright custom kitchen with cherry cabinets, [...]

- 5 beds
- 3.00 baths
- Residential W/Land
- Residential
- Active
- 5228 sq ft

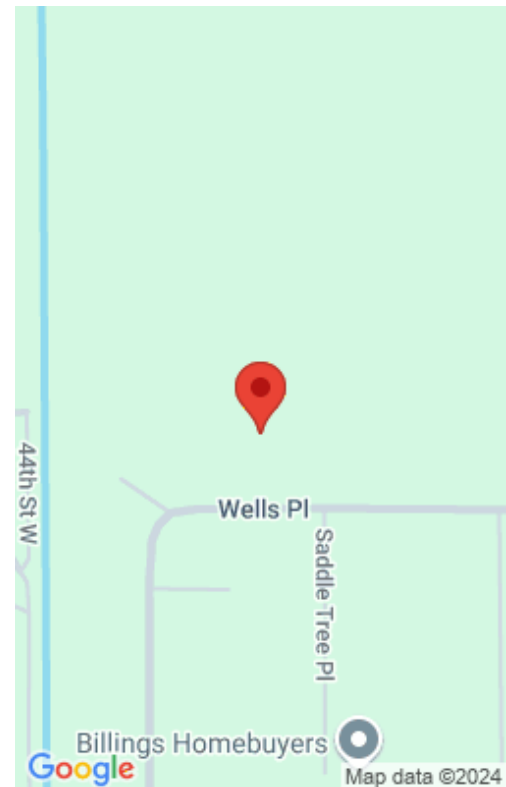

Basics

Category: Residential

Status: Active

Bathrooms: 3.00 baths

Area: 5228 sq ft

Year built: 1982, Historical

Baths Full: 3

DOM: 57

Type: Residential W/Land

Bedrooms: 5 beds

Half baths: 0 half baths

Lot size: 43996 sq ft

Zone: Residential 15000

County Or Parish: Yellowstone

Building Details

Basement Finish: 100%

Color: Tan

Number of Levels: 1

Basement: Full Basement

Roof: Asphalt, Shingle

Sq Ft Basement: 2344 sq ft

Other Structures: Shed

Garage Description: Attached

Exterior material: Brick, Wood

Amenities & Features

Sewer: Septic Tank

Style: Ranch

Other Appliances: Disposal, Water Softener Owned

Heating: Gas Forced Air, Other

Features: Deck or Patio, Fenced, Garage Opener

Cooling: Central

Tot Fireplaces: 2

Interior Features: Ceiling Fan, Humidifier, Pantry, Skylight

Exterior Features: Deck, Garden, Gazebo, Under Ground Sprinkler

Miscellaneous



Restrictions: See Deed

Virtual Tour Link:

<https://www.propertypanorama.com/instaview/bmt/347170>

Possession: At Closing

Showing Instructions: Appointment Needed, Call Agent, Lock Box, Text Agent

Subdivision: Shiloh Estates

Parcel Number: C07661

List Office Name:
Engel & Voelkers

Nearby Schools

Junior High School: Ben Steele

High School: West

Elementary School: Meadowlark

Fees and Taxes

Tot Taxes: \$4,835

